

SECTION DETAIL - FLOOR SCREED

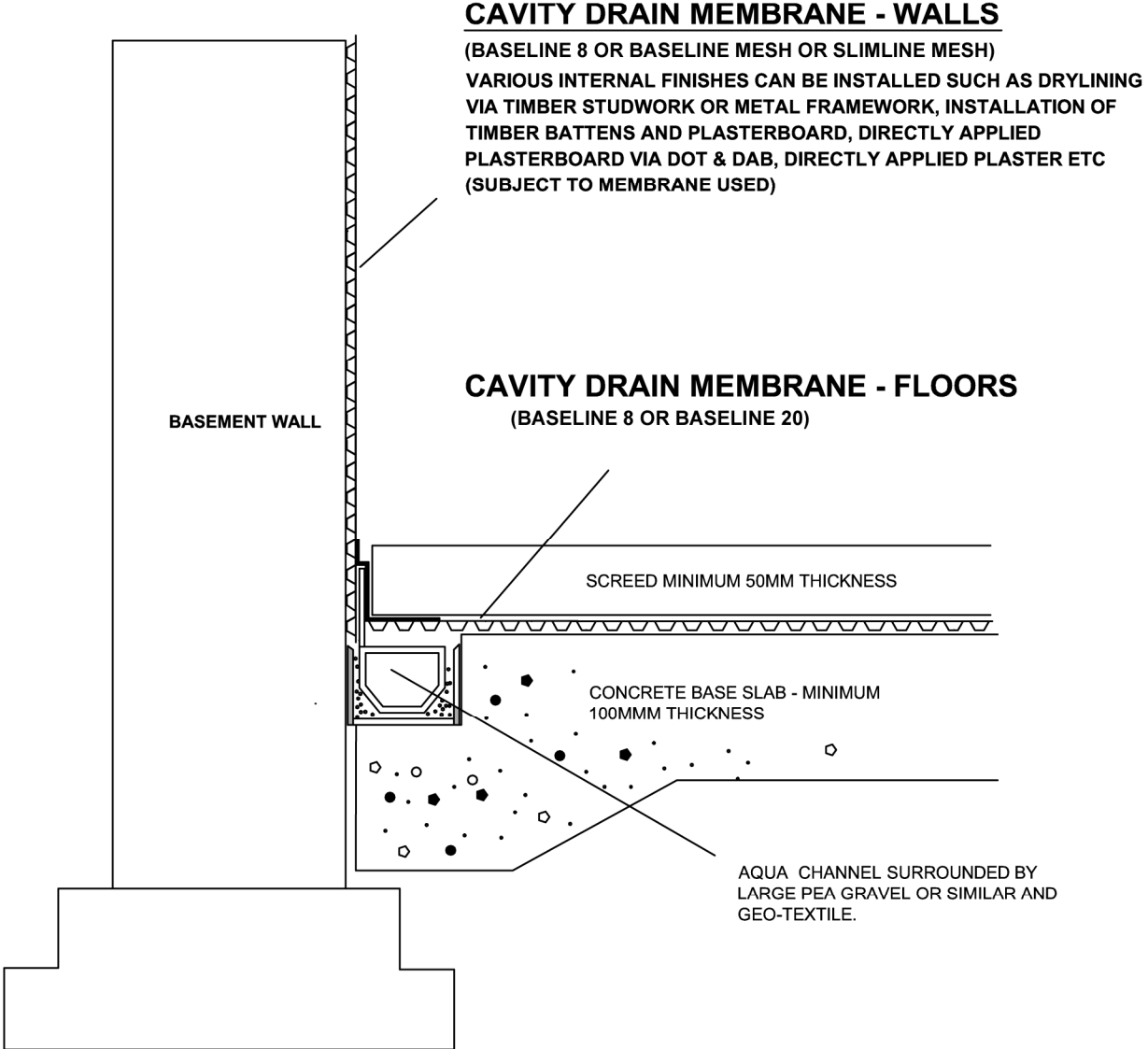

CAVITY DRAIN MEMBRANE - WALLS

(BASELINE 8 OR BASELINE MESH OR SLIMLINE MESH)
VARIOUS INTERNAL FINISHES CAN BE INSTALLED SUCH AS DRYLINING VIA TIMBER STUDWORK OR METAL FRAMEWORK, INSTALLATION OF TIMBER BATTENS AND PLASTERBOARD, DIRECTLY APPLIED PLASTERBOARD VIA DOT & DAB, DIRECTLY APPLIED PLASTER ETC (SUBJECT TO MEMBRANE USED)

CAVITY DRAIN MEMBRANE - FLOORS

(BASELINE 8 OR BASELINE 20)

BASEMENT WALL

SCREED MINIMUM 50MM THICKNESS

CONCRETE BASE SLAB - MINIMUM 100MMM THICKNESS

AQUA CHANNEL SURROUNDED BY LARGE PEA GRAVEL OR SIMILAR AND GEO-TEXTILE.

CELLAR MEMBRANE & DRAINAGE
DRAWING DETAIL - TW006A

SKETCH PLAN - NOT TO SCALE

Twistfix Group
81 Oxford Street
London W1D 2EU
6th Floor, 8 Exchange Quay
Manchester M5 3EJ

Tech Tel: 0845 123 6006
Sales Tel: 0845 123 6007
Email: sales@twistfix.co.uk
Web: www.twistfix.co.uk

buy at
twistfix[®].co.uk