

FILLET SEAL

CEMENTITIOUS WATERPROOFING SYSTEM

FUNCTION

A cement based, rapid curing non shrink hydraulic setting powder. Used at points of stress i.e. floor/wall or wall/wall junction and applied normally by trowel..

DESCRIPTION

Grey powder. Bulk density approx. 1.4 kg/l

USES

One of the potentially weakest points of any structural waterproofing application process is the floor/wall junction and particular attention to this detail is required.

Wykamol Fillet Seal is specifically formulated to tackle this problem area as part of their tanking system using either AquaSTOP or HydraDRY tanking slurries.

APPLICATION

At floor wall junction chase out the floor to a minimum of 25mm from the wall and 25mm into the floor, cutting into the wall where possible.

Flush out chase formed to remove grit dust etc., and whilst still damp fill chase with Wykamol Fillet Seal. Press fully into chase and whilst still green form a "bottle" cove.

Apply Wykamol Fillet Seal to all vertical internal angles and again form a rounded "bottle" cove.

Wykamol Fillet Seal should also be applied to the wall/ceiling joints of vaults if relevant.

COVERAGE

Applied at a rate of 15-20 linear metres per 25kg bag subject to site conditions and requirements

PRODUCT DATA

Appearance: Pale grey powder.
Pack Size: 25kg bag
Shelf Life: 6 months
Storage: Store in a cool dry place

TECHNICAL INFORMATION

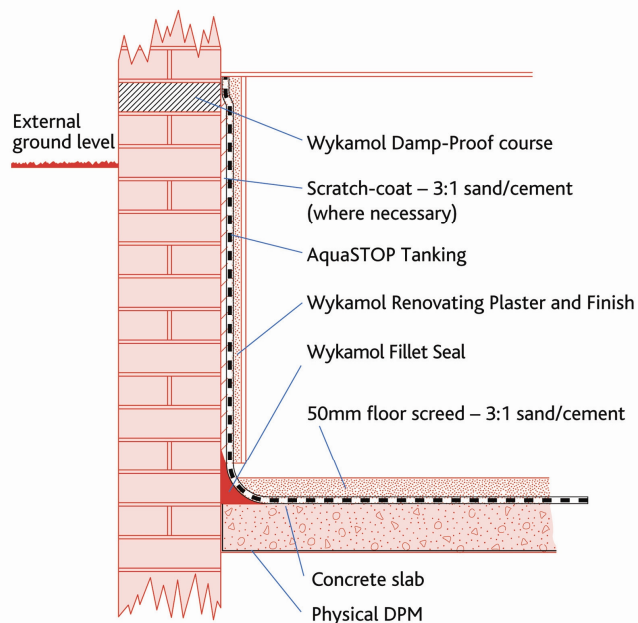

Wall/Floor Junction (application diagram)

This data sheet is intended for the use of professional remedial operators and is compiled accordingly. For further advice on the use of Wykamol products, contact the Technical Department at the address below.