

# Pinning Cross Walls

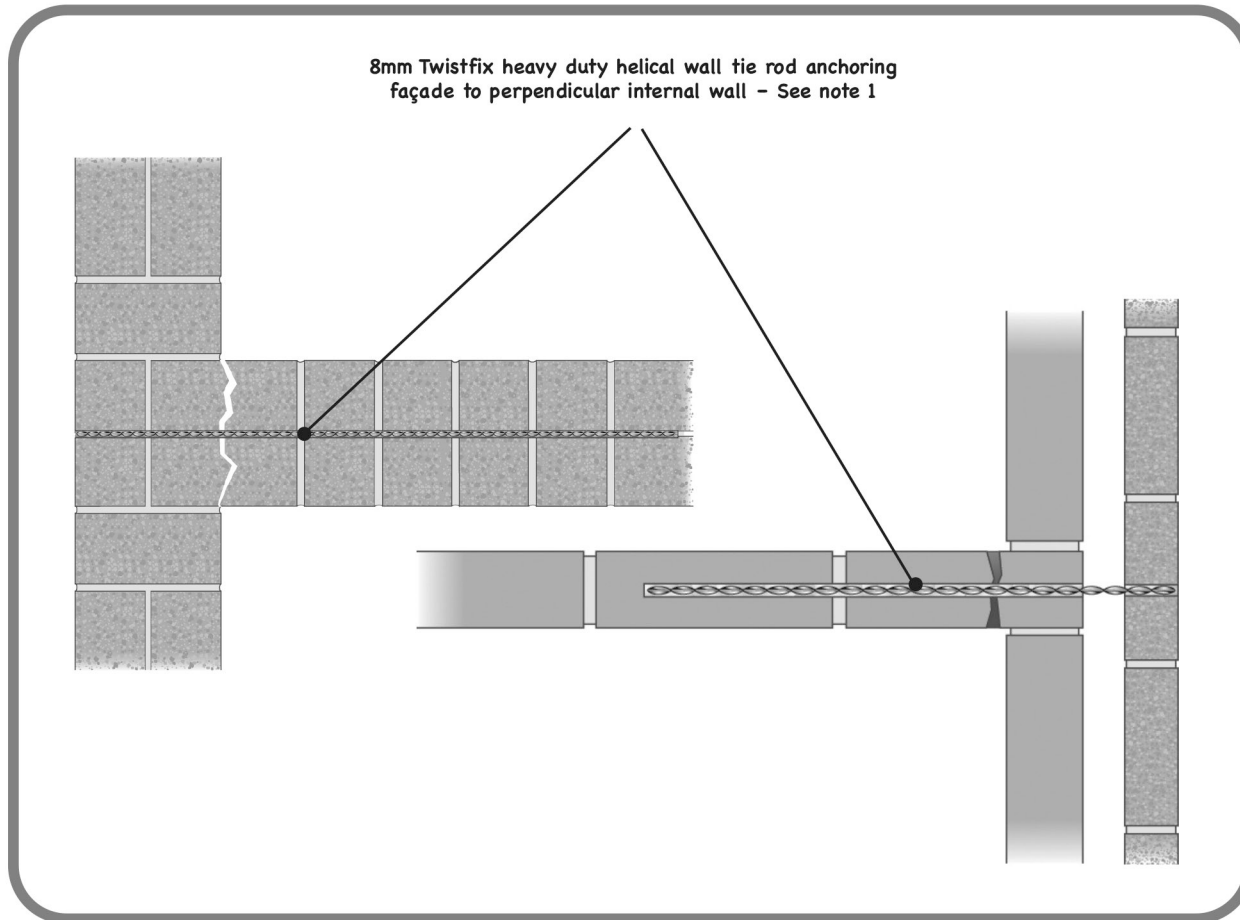

## METHOD STATEMENTS & NOTES

1. Drill 14-16mm anchorage holes at least 500mm beyond cracked wall junction. Flush with clean water and fill hole with WHO-60 grout. Insert tie fully into grout and leave grout to set. Make good drill hole to match.

Ties should be spaced at 300mm centres vertically

## REINFORCEMENT SPECIFICATION

- Material: 304 Series Stainless Steel
- Ult. Tensile Strength: 1025-1225N/mm<sup>2</sup>
- Nominal CSA: 8mm Bar = 13mm<sup>2</sup>

## GROUT SPECIFICATION AT 28 DAYS

- Compressive Strength: 55N/mm<sup>2</sup>
- Tensile Strength: 5N/mm<sup>2</sup>
- Flexural Strength: 12N/mm<sup>2</sup>
- Youngs Modulus: 13N/mm<sup>2</sup>

Engineers, surveyors and contractors should refer to BRE Good Building Guide 62.

[sales@twistfix.co.uk](mailto:sales@twistfix.co.uk)